



POWERSPORTS

CAUTION

THIS MINI BIKE WAS
SHIPPED WITHOUT
ENGINE OIL.
ALWAYS FILL WITH THE
CORRECT AMOUNT AND
GRADE OF ENGINE OIL
AS LISTED IN THE
OWNER'S MANUAL

ASSEMBLY/PRE-RIDE INSPECTION INSTRUCTIONS

BT200X

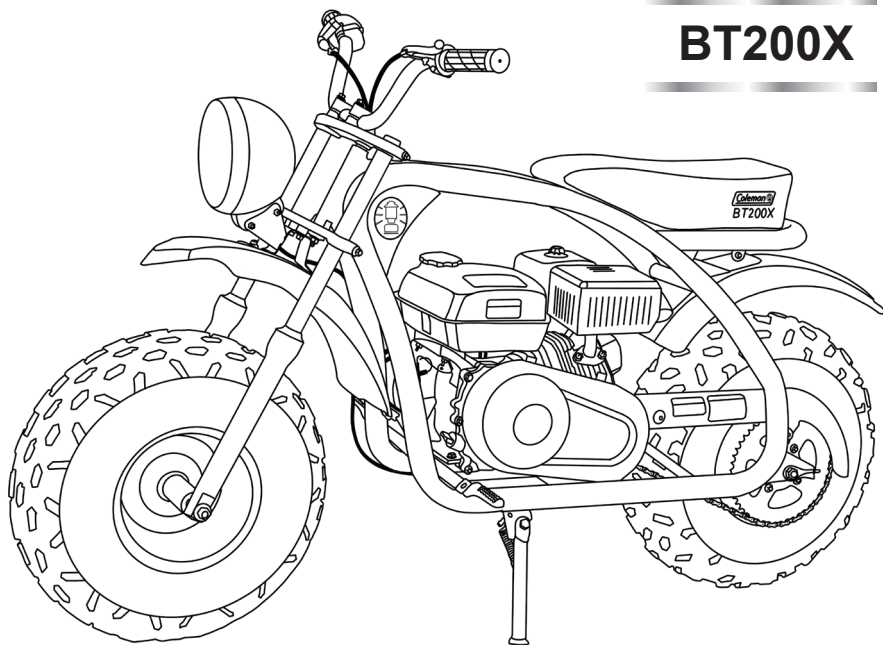

For questions about these Assembly Instructions, call
Coleman Powersports toll free 888-405-8725



WARNING

NEVER ATTEMPT TO START THIS MINI BIKE WITHOUT READING
AND UNDERSTANDING THE OWNER'S/ OPERATOR'S MANUAL.
THE OWNER'S OPERATOR'S MANUAL PROVIDES INFORMATION
ON SAFETY, PARTS, FUNCTIONS, PRE-RIDE INSPECTION,
STARTING AND MAINTENANCE

REMOVAL FROM CRATE



Owner's/Operator's Manual



Tool Kit

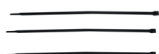

Zip Ties



**Front Fork
Suspension**



M10 Steering Bolt



**M10 Small
Washers**



M10 Lock Nut



M10 Large Washers

**Front Fork
Assembly**



M8 x 50 Bolts



Light



M8 Nuts



**M8 Rubber
Grommets**

Light Assembly



Clamps



M8 x 32 bolts

Handle Bar Hardware



Front Fender



M8 x 20 Bolts



8mm Large Washers



M8 Nuts



**M8 x 15 Bolts
Light/Fender bracket**

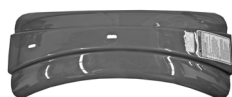

Rear Fender



M8 x 20 Bolts



8mm Large Washers



M8 Nuts

**Rear Fender
Assembly**



Front wheel



M14 Axle Bolt



M14 Washers



M14 Lock Nut

Front Wheel Assembly

FRONT FORK INSTALLATION

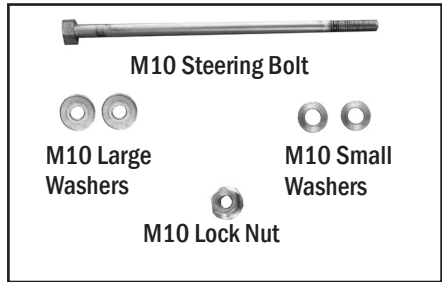
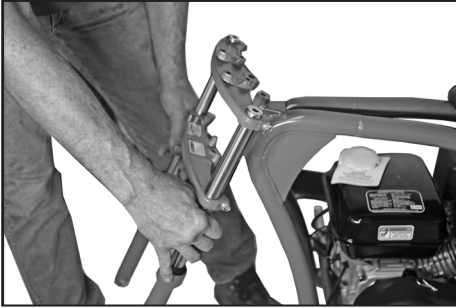

1. Install front Fork Assembly by inserting the M10 steering bolt through the assembly in the following order: Large washer, Top bracket, Small Washer, Steering Neck, Small washer, Bottom bracket, Large Large Washer, Lock Nut

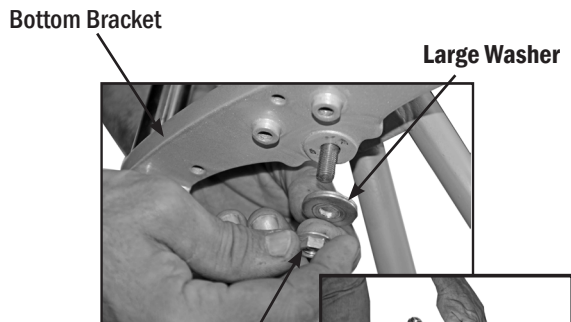
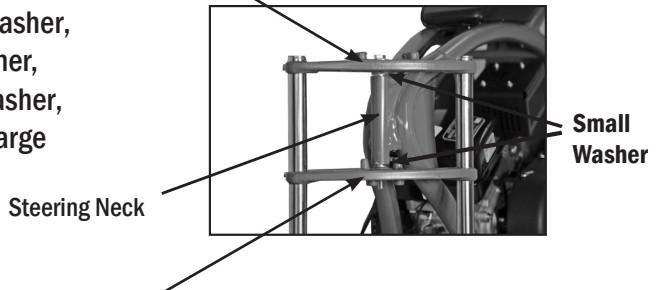
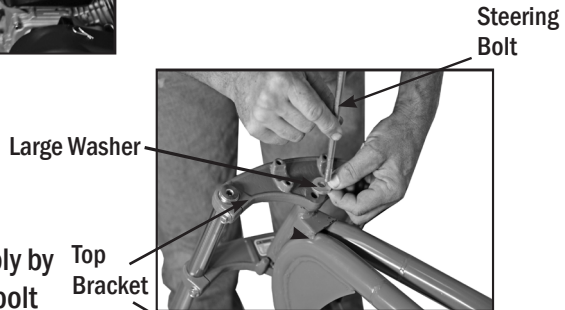

2. Tighten Lock nut

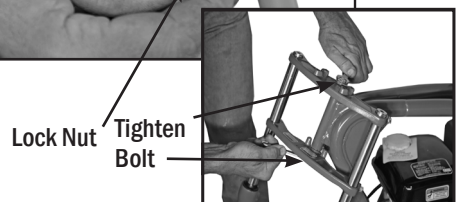

3. Tighten fork bolts on both sides of assembly

Torque for bolts 15 Ft/Lbs.

Fork Bolts

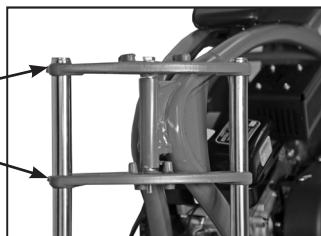

LIGHT/FENDER BRACKET INSTALLATION



M8 x15 Bolts

1. Attach Light/Fender bracket using M8 x 15 bolts

Torque bolts
15 ft/lbs.

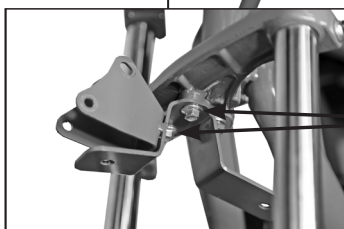
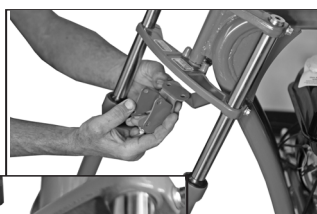

M8 X 15
bolts

FRONT FENDER INSTALLATION



M8 x 20 Bolts



M8 Nuts



Large M8
Washers

1. Attach front fender with M8 x 20 bolts, large M8 washers and M8 nuts.

Torque bolts
15 ft/lbs.

M8x20 bolts

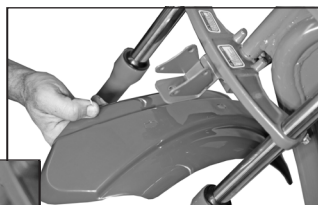
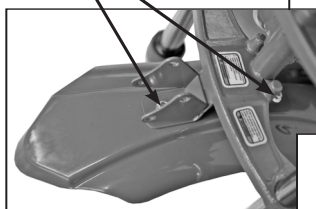

Large M8 Washers
M8 Nuts

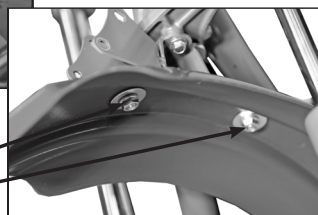

REAR FENDER INSTALLATION

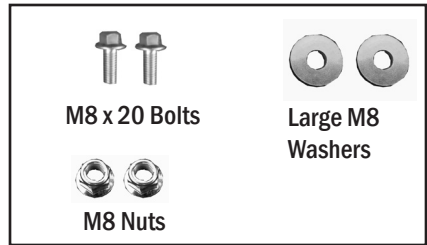

1. Attach Rear fender with M8 x 20 bolts, large M8 washers and M8 nuts.

Torque bolts 15 ft/lbs.

M8 x 20mm Bolts



Large M8 Washers
M8 Nuts

Bottom View

HANDLEBAR ASSEMBLY



1. Lift up handle bars and center on fork assembly.

CAUTION:

While installing handlebars make sure brake cables, throttle cable and on/off switch wire are not kinked or pinched.

2. Attach handlebars using clamps and M8 x 32 Bolts

Torque bolts 15 ft/lbs.

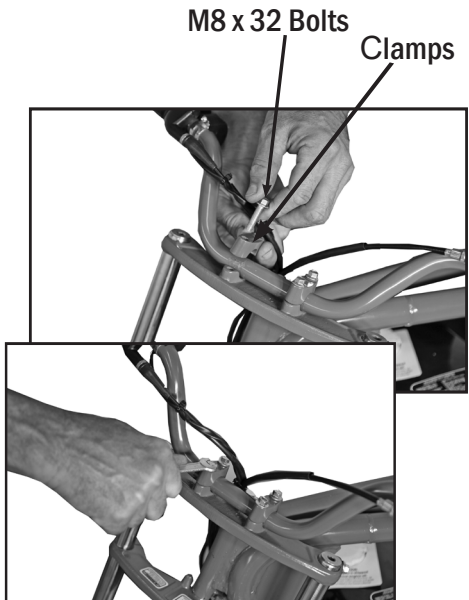
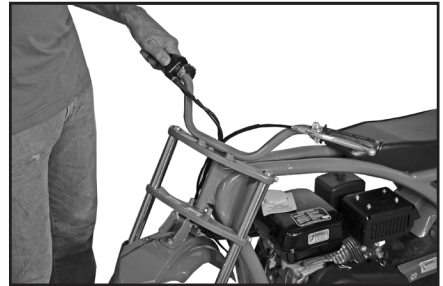

FRONT WHEEL INSTALLATION

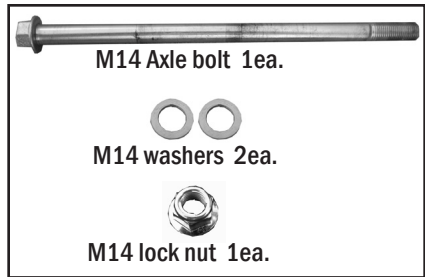

1. Orient the front tire so the arrow on the tire faces forward.
2. Insert Axle bolt with the M14 washers between the forks and wheel on each side.
3. Install M14 lock nut and tighten.

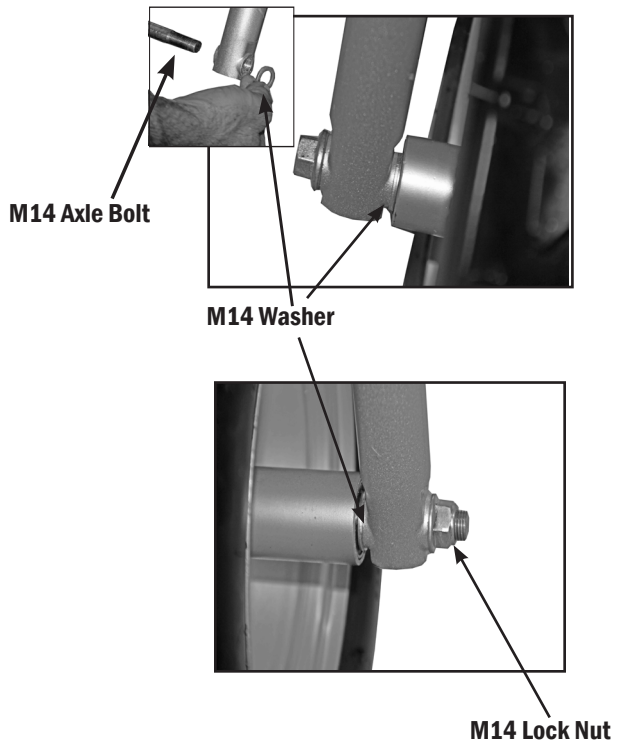
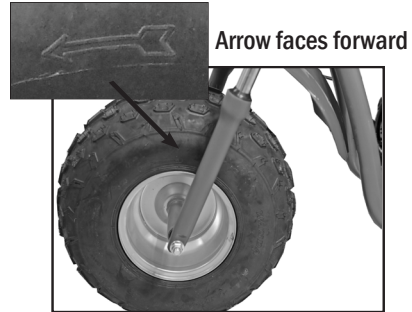

LIGHT INSTALLATION

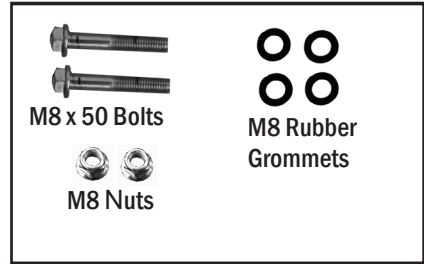

1. Install front light onto bracket using M8 X 50 bolts, M8 rubber grommets and M8 nuts.

Note: The rubber grommets fit between the light and the light bracket

Torque Bolts 12ft/lbs

Rubber Grommets between light and light bracket

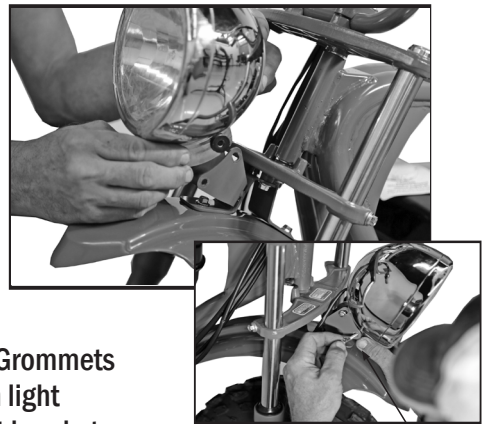

M8 x 50 Bolts

M8 Nuts

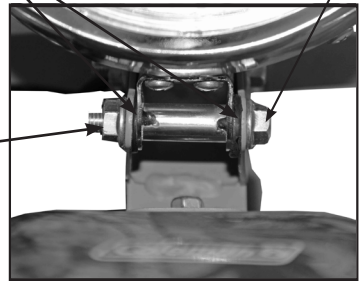

2. Plug light wires into wires from engine assembly



SECURE WIRES AND CABLES

INSTALL CLUTCH COVER

1. Make sure the On/Off Switch wire, throttle cable and brake cable are not kinked and have free movement when the handle bars are turned from left to right.



Zip Ties

2. Secure wires and cables to frame using the Zip ties provided.



Zip Ties

WARNING

ALWAYS CHECK THROTTLE CABLE BEFORE STARTING ENGINE, THE THROTTLE CABLE SHOULD HAVE FREE MOVEMENT AND SNAP BACK TO IDLE WHEN RELEASED.

OIL AND FUEL

Engine Oil

Mini bike is shipped without engine oil, fill with SAE 10W-30 Motor Oil.

Refer to owner's manual for correct amount and grade of engine oil.

Caution: Do not over or under fill with engine oil

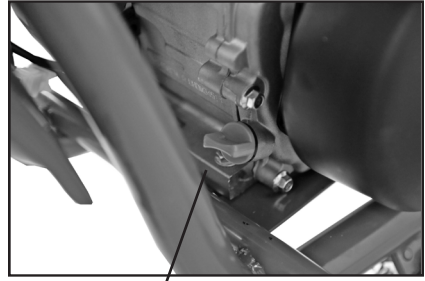

1



FUEL

Never use leaded gasoline in this product. It could affect the engine's emissions and damage the engine.

Mini Bike requires clean unleaded regular gasoline with a minimum octane rating of 86 or higher.

Fill with gasoline up to the bottom of the filler neck.

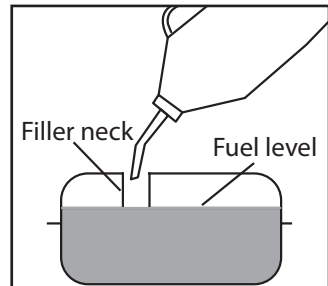

TIRE PRESSURE

Tires

1. Check tire pressure. Incorrect tire pressure can affect the handling, rider comfort, steering, tire life and traction. Always check the tire pressure before each ride.

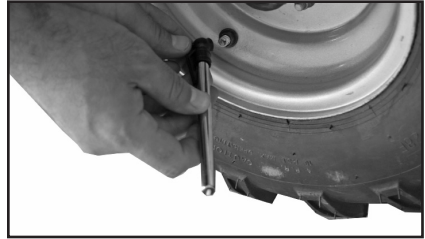

Tire pressure

Front tires: 10psi

Rear tires: 10psi

Chain tension

Check the tension of the chain , The chain (1) tension should be $1/2 - 3/4$ in. (15-20mm)

Chain tension (slack) adjustment

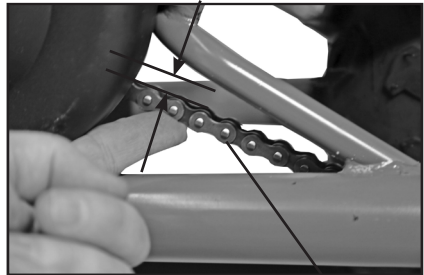

$1/2 - 3/4$ in.
(15-20mm)

1

1. Loosen bolt (2) on the rear axle assembly.

2. Adjust chain tension by turning the tension nuts (3) (Note: Tension nuts are located on both sides of the mini bike.) Clockwise will tighten the chain. Counter clockwise will loosen the chain.

3. Once the chain is at the correct tension re-tighten axle bolt (2).

4. Re-check chain tension.

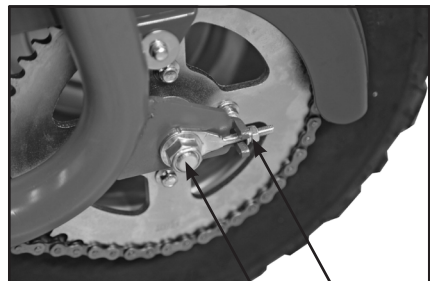

2

3

BRAKE ADJUSTMENT

Brakes

Brake Lever Adjustment

The front left brake lever (1) should have 2.0 - 4.0mm (0.08 - 0.16) of free play.

To adjust brake lever free play:

1. Loosen the jam nut (2) on the brake cable.
2. Turn the adjuster nut (3) until the correct amount of free-play is achieved.
3. Re tighten jam nut (2)

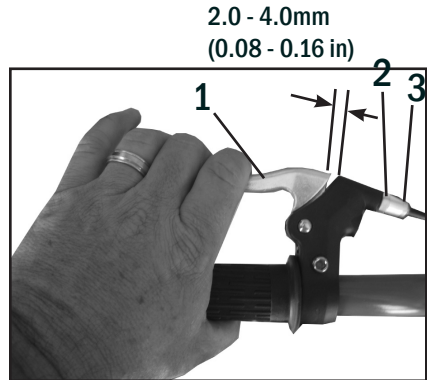

Brake Adjustment

To adjust brakes, loosen the rear axle bolt (4)

Locate the adjustment nut (5) located on the rear brake drum assembly.

To adjust brakes, turn the adjusting nut (5) clockwise to increase braking, counter clockwise to decrease braking.

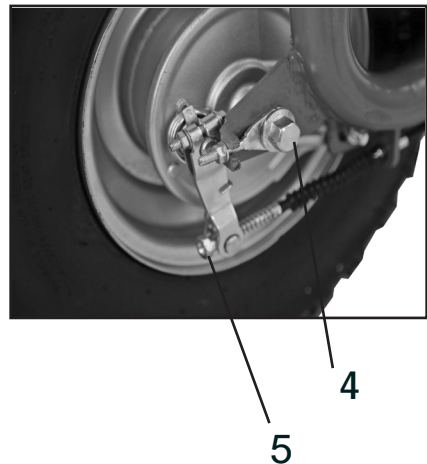

THROTTLE ADJUSTMENT

Throttle Cable adjustment

It is important that the throttle grip have a certain amount of free play .

The hand grip throttle free play (2) should be .078 - .24 in (2-6 mm)

To adjust freeplay

1. Loosen jam nut (3)
2. Turn adjusting nut (4) to proper setting
3. Once throttle grip is at the proper freeplay, re-tighten the jam nut (3).



PRE-RIDE INSPECTION

Inspecting and checking the condition of the Mini Bike before each ride is important. Following the pre-ride check list will help insure there are no problems which could result in injury or becoming stranded. Make sure the Mini Bike is in good operating condition before each ride.

WARNING

Failing to inspect and maintain the Mini Bike could be hazardous.

Not following the pre-ride inspection procedures could result in losing control of the Mini Bike resulting in an accident or damage to the Mini Bike

Always perform a Pre-ride inspection before each ride.

WARNING

Performing maintenance and checks while the engine is running could be hazardous.

You could be severely injured by moving parts or hot surfaces.

Never perform maintenance or check procedures while the engine is running with the exception of checking the engine stop switch or throttle.

WHAT TO CHECK	CHECK FOR
Steering	<ul style="list-style-type: none">• Smoothness• No restriction of movement
Brakes	<ul style="list-style-type: none">• Proper brake lever play
Tires	<ul style="list-style-type: none">• Proper tire pressure
Fuel Tank	<ul style="list-style-type: none">• Enough fuel for the ride• Fuel cap secure• Hoses have no signs of cracks or leaks
Throttle grip	<ul style="list-style-type: none">• Throttle grip snaps back to idle when released• Operates freely• Has correct free play
Engine Stop Switch	<ul style="list-style-type: none">• Switch shuts off engine when activated.
Engine Oil	<ul style="list-style-type: none">• Correct oil level
Drive Chain	<ul style="list-style-type: none">• Proper tension• Lubricated
General Condition	<ul style="list-style-type: none">• All nuts and bolts tight• No rattles from engine or frame while running

STARTING ENGINE

STARTING ENGINE

To start the engine

1. Place the fuel valve (1) to the “ON” (right) position
- 2.. If engine is cold, place the choke lever (2) to the “ON” (left) position.
3. Place the ON/OFF switch (3), located on the handlebars, to the (on)position.
4. Pull the starter recoil cord to start the engine.
5. Once engine has warmed up for a few minutes, place the choke lever (2) back to the “OFF” (right) position.

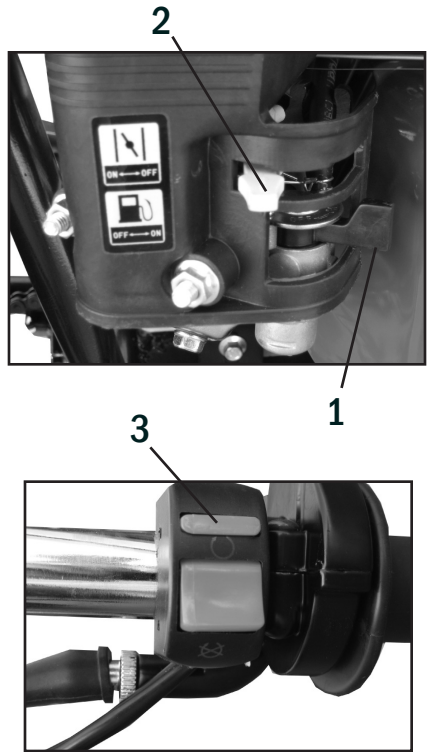

⚠ WARNING

Starting or running the Mini Bike in an enclosed area such as a garage or shed where there is no ventilation is hazardous.

Inhaling exhaust fumes from the Mini Bike can cause severe injury or death.

Never start or run the Mini Bike in an inclosed environment where there is no ventilation. Always start and run outdoors.

WARNING

NEVER ATTEMPT TO START THIS MINI BIKE WITHOUT READING AND UNDERSTANDING THE OWNER'S/ OPERATOR'S MANUAL. THE OWNER'S/ OPERATOR'S MANUAL PROVIDES INFORMATION ON SAFETY, PARTS, FUNCTIONS, PRE-RIDE INSPECTION, STARTING AND MAINTENANCE



POWERSPORTS

(888) 405-8725

1775 E. University Dr., Tempe, AZ 85281

www.colemanpowersportsusa.com

www.facebook.com/colemanpowersportusa.com

www.instagram.com/colemanpowersports_usa

